

Waste Water Treatment

Septage Receiving Stations VFA DM

32



Description ▼

Septage Receiving Stations VFA DM consist of a dual motor drive system, a perforated plate drum screen complete with screw conveyor and compaction zone, all installed in a tank.

As the septage tanker truck approaches the plant, it is connected to the septage receiving station by means of a Perrot joint. This way the truck starts unloading the sludge into the station. Liquids are conveyed to the purification process while solid waste is kept, washed and compacted.

The Septage Receiving Station VFA DM is equipped with a perforated plate VSA drum screen which washes, conveys and dewater waste water screenings.

Both screen basket and dewatering zone are self-cleaning. Rotating around its axis, the cylindrical filter conveys the screenings to a loading hopper placed in the centre. A set of spray nozzles washes the filter during operation. A screw, placed inside the conveying pipe, with its top in the discharge hopper, conveys the screenings towards the following treatment stages during which organic substances are washed out. Subsequently, solids are compacted and dewatered in the compacting and drainage area. Finally, solids are discharged through a discharge chute.

Application ▼



Benefits ▼

- ✓ Dual motor drive system – drum and auger driven independently
- ✓ 4 RPM drum speed and 10 RPM auger speed optimise cleaning efficiency and solids removal.
- ✓ 25° angle of inclination increases solids capacity
- ✓ Tank design prevents sedimentation
- ✓ Extended hopper increases solids capturing efficiency
- ✓ No lower drum support arm eliminates rag accumulation



www.savi-water.com
www.wamgroup.com

Waste Water Treatment

Septage Receiving Stations VFA DM



Technical Features / Performance ▼

- ▶ 3 sizes
- ▶ Solids concentration up to 2-3%
- ▶ Dual motor drive system
- ▶ Drum screen openings 5.0 – 6.0 mm round holes
- ▶ Drum screen incline angle: 25°
- ▶ Frame manufactured from 304 L / 316 L SS
- ▶ Spiral manufactured from special ST 52 steel, or 304 L / 316 L SS
- ▶ Control panel (option)
- ▶ Bagger (option)

PERFORMANCE		
AVAILABLE SPACINGS: 5 - 6 mm		
MODEL	FLOW RATES - m ³ /h	COMPACTION PERCENTAGE
VFA 800 DM	100	30%
VFA 1200 DM	150	30%
VFA 1400 DM	200	30%

Overall Dimensions ▼

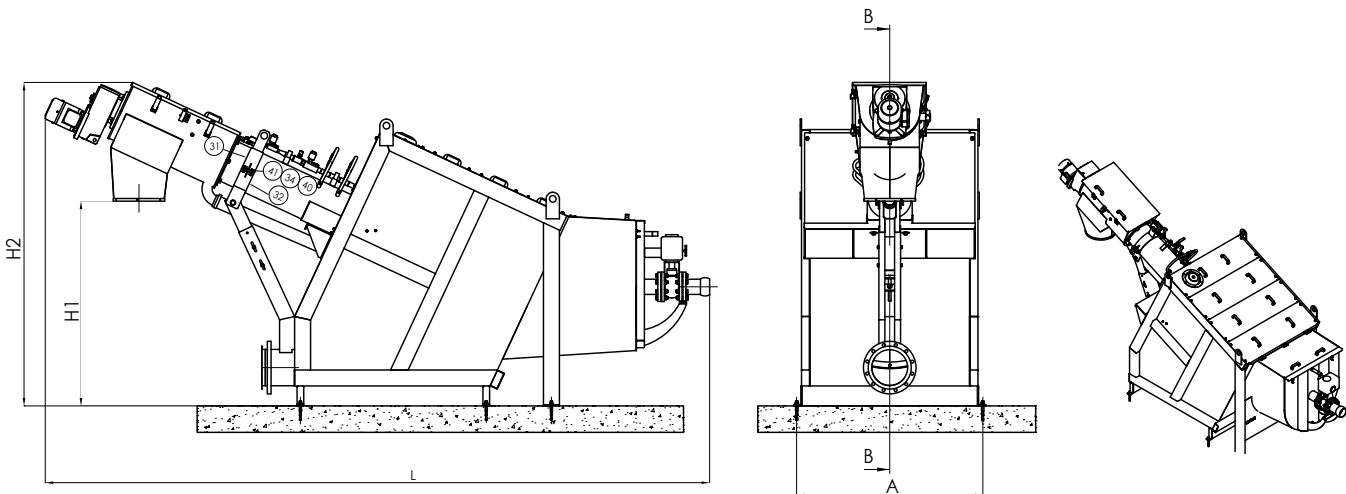

VFA DM - SEPTAGE RECEIVING STATION									
MODEL	TOTAL WIDTH A mm	TOTAL LENGTH L mm	DISCHARGE HEIGHT H1 m	TOTAL HEIGHT H2 mm	INLET MOTORISED VALVE	FLANGED OUTLET	WASH WATER CONSUMPTION	DRUM MOTOR POWER kW	SPIRAL MOTOR POWER kW
VFA 800 DM	1,100	5,000	1,500	2,400	DN 100	DN 200	120 l/min at 5 bar	1.1	1.1
VFA 1200 DM	1,400	5,000	1,600	2,500	DN 100	DN 250	150 l/min at 5 bar	1.5	1.5
VFA 1400 DM	1,600	5,600	1,800	2,700	DN 100	DN 250	200 l/min at 5 bar	1.5	1.5

DS-VFA DM-EN December 2017_R00 Rights reserved to modify technical specifications.



www.savi-water.com
www.wamgroup.com