

Submersible Agitators SE

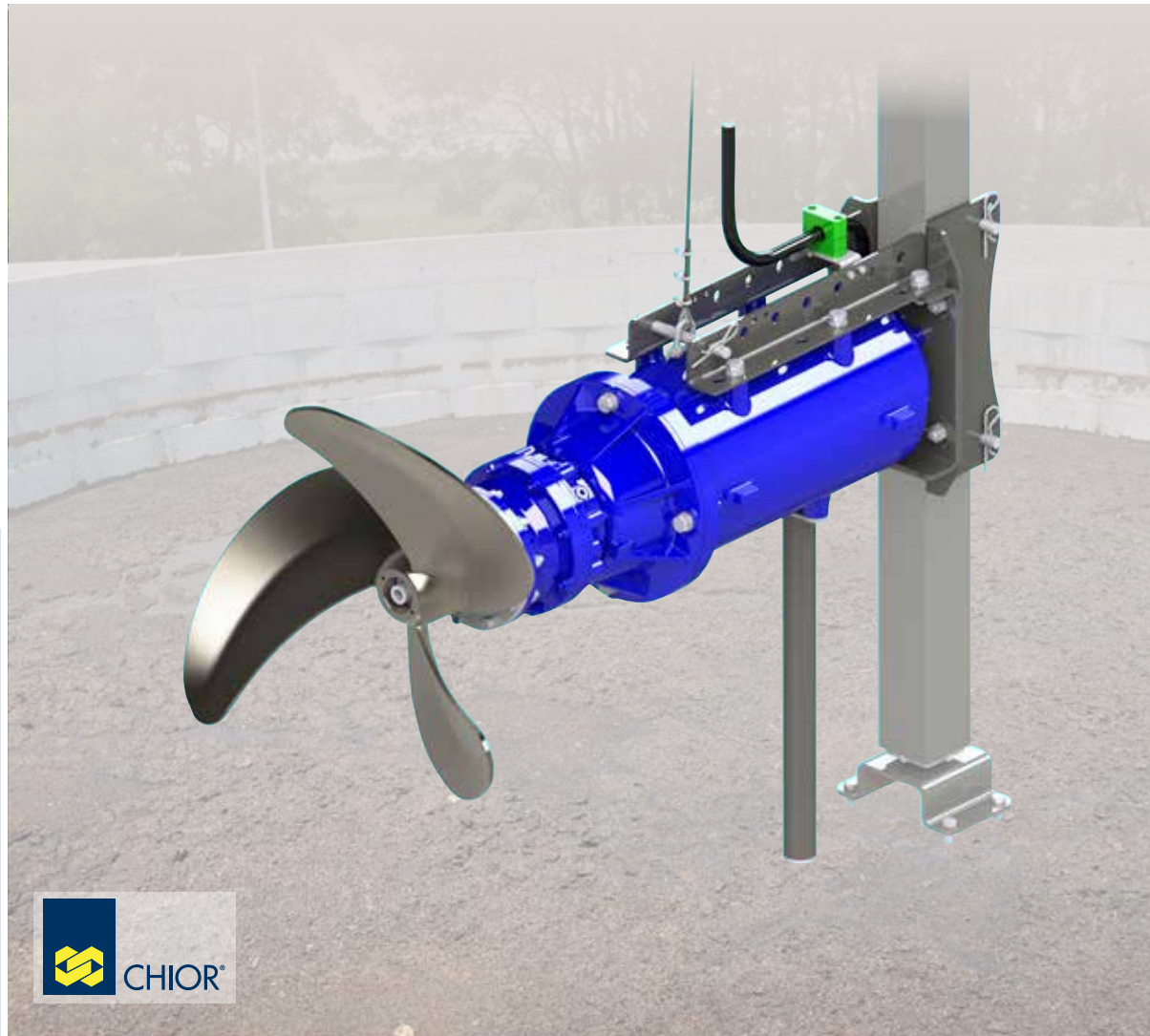

**ATEX version
available**



SAVECOTM
A WAMGROUP® Brand

HIGHLY EFFICIENT, RELIABLE AND EASY TO INSTALL

CHIOR® SE Submersible Agitators find their main application in mixing livestock effluents in open tanks as well as in anaerobic digesters. The particular shape of the stainless-steel propeller guarantees high mixing efficiency even with effluents with a high solids content.

Provided with an adjustable stainless steel bracket, CHIOR® SE Submersible Agitators allow quick installation on a vertical pipe.

CHIOR® SE Submersible Agitators can be supplied with three different rotation speeds depending on the installed gear reducer.

MODEL	RPM	Mixing performance:		Suitable for:
		Boost (N)	Flow Rate (m ³ / h)	
SE Quick (VE)	355	5,600	10,000	crushing of surface crust
SE Standard (ST)	280	5,800	12,000	most applications
SE Slow (LE)	140	6,000	16,000	primary handling of large volumes

Technical Data

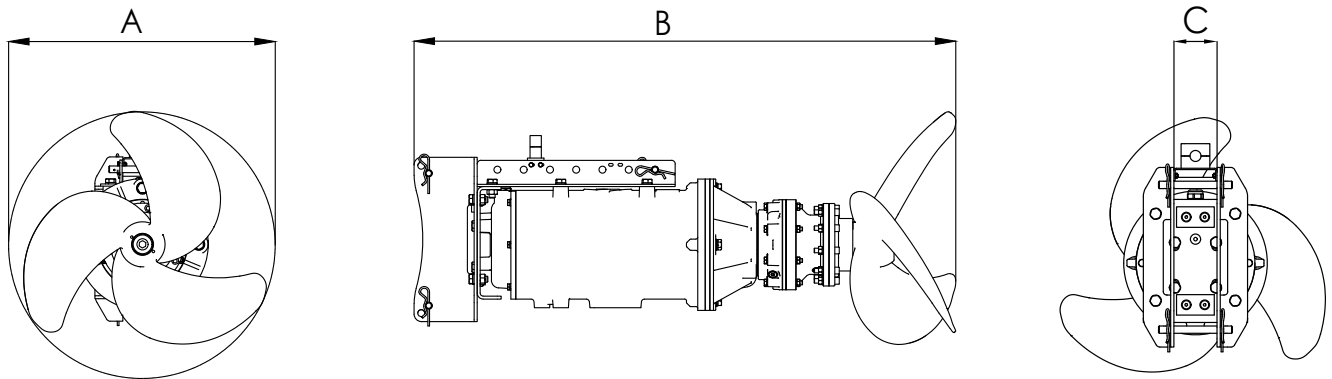

MODEL	Drive Power (kW)	RPM	Weight (kg)	Dimensions (mm)		
				A	B	C
SE-110-LE	11.0	140	300	1,000	1,605	100 ~ 120
SE-150-LE	15.0	140	330	1,200	1,650	100 ~ 120
SE-110-ST	11.0	280	270	600	1,405	100 ~ 120
SE-150-ST	15.0	280	285	670	1,435	100 ~ 120
SE-185-ST	18.5	280	305	710	1,450	100 ~ 120
SE-220-ST	22.0	280	330	780	1,475	100 ~ 120
SE-110-VE	11.0	355	260	510	1,375	100 ~ 120
SE-150-VE	15.0	355	275	560	1,390	100 ~ 120
SE-185-VE	18.5	355	290	660	1,430	100 ~ 120
SE-220-VE	22.0	355	300	700	1,445	100 ~ 120

Benefits

- ✓ **High-efficiency motor with low energy consumption**
- ✓ **Designed to prevent leakage and provide durability**
- ✓ **Engineered 3-flight propeller with high mixing effect**

- ✓ **Easy maintenance thanks to modular design**

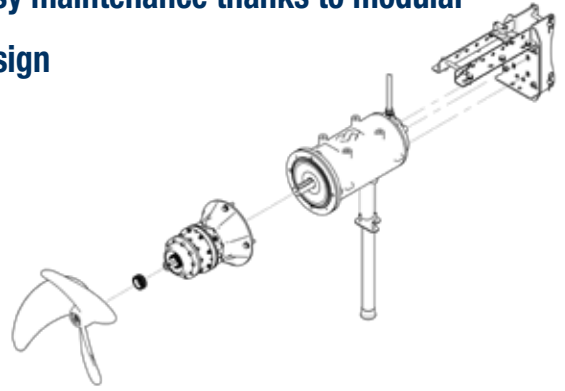

Technical Features

- Cast iron body
- Submersible IE3 motor (Premium Efficiency)
- 3-phase, 4-pole, insulation class F electric motor
- IP68 motor protection
- Thermal probe to prevent overheating of electric motor
- Cemented carbide mechanical seals
- Self-lubricating radial ball bearings
- NBR O-ring seals
- 21 mm diameter EM7 rubber-sheathed cable with stainless-steel cable gland
- Adjustable 304 SS support
- Stainless-steel limit switch foot



**ATEX version
available**

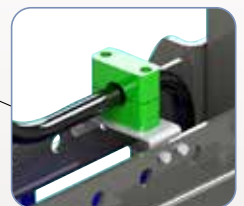
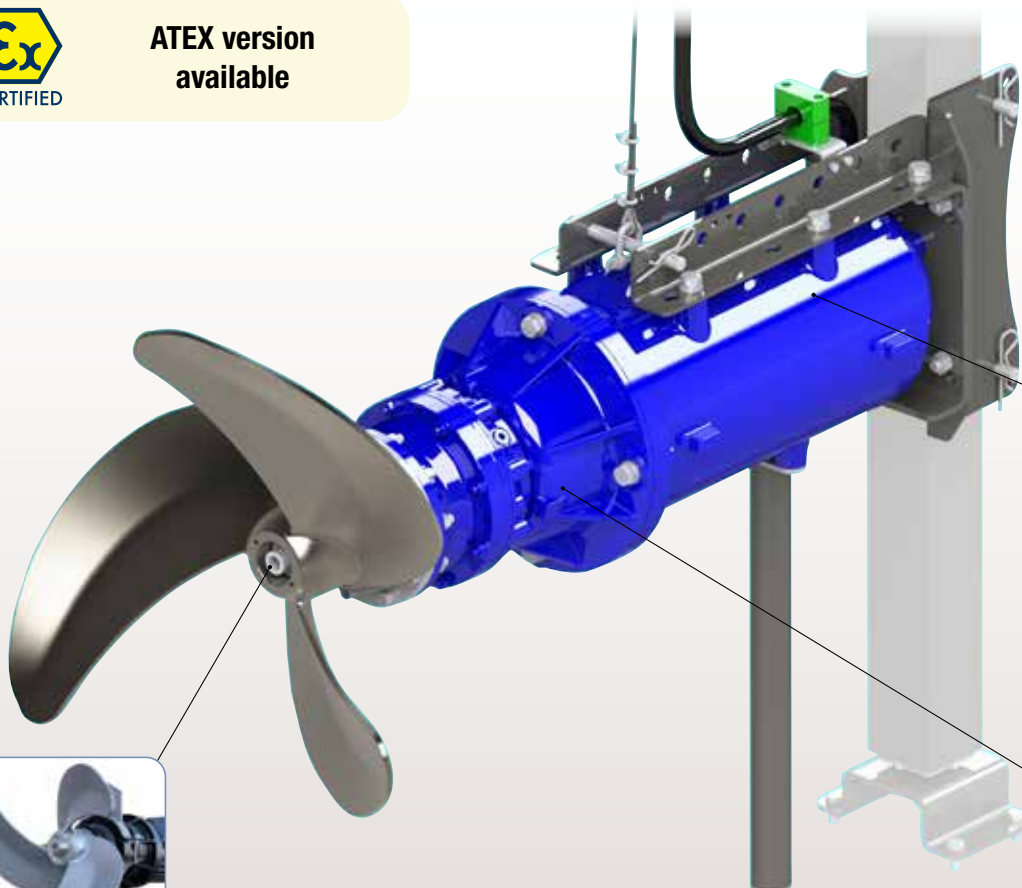

Electrical cable with strain relief system



Planetary gear reduction unit available in 3 versions (140/280/355 rpm)



Engineered 304 SS three-flight propeller

Application



202001716 Aprile 2021 Rights reserved to modify technical specifications.

This brochure has been edited for distribution in European Union countries



SAVECOTM
A WAMGROUP® Brand



www.saveco-water.com