

1.1
CONSEP® 5000 SPARE PARTS

Pos.	DESCRIPTION	CODE	SPARE PARTS RECOMMENDED
1	Batcher		X
2	Lower bearing (pair)		X
3	Scraper blade		
4	Wear-proof flight sector made of technopolymer		X
5	Complete screw		
6	Trough grille		
7	Supporting belt		
8	Sliding belt		
9	Gearbox		
10	Electric motor		
11	Belt transmission		
12	Water regulator cock		
13	Washing nozzles		
14	Aggregates filter		
15	Supporting foot		

1.2
FEEDER AL 4000® SPARE PARTS

Pos.	DESCRIPTION	CODE	SPARE PARTS RECOMMENDED
1	Trough grille		
2	Batcher		X
3	Scraper blade		
4	Wear-proof flight sector made of technopolymer		
5	Front sealing ring		X
6	Complete sealing unit		
7	Supporting belt		
8	Sliding belt		
9	End bearing (pair)		X
10	Complete screw		
11	Gearbox		
12	Electric motor		
13	Load side bearing		X
14	Chain transmission (chain + sprockets)		X
15	Supporting feet		

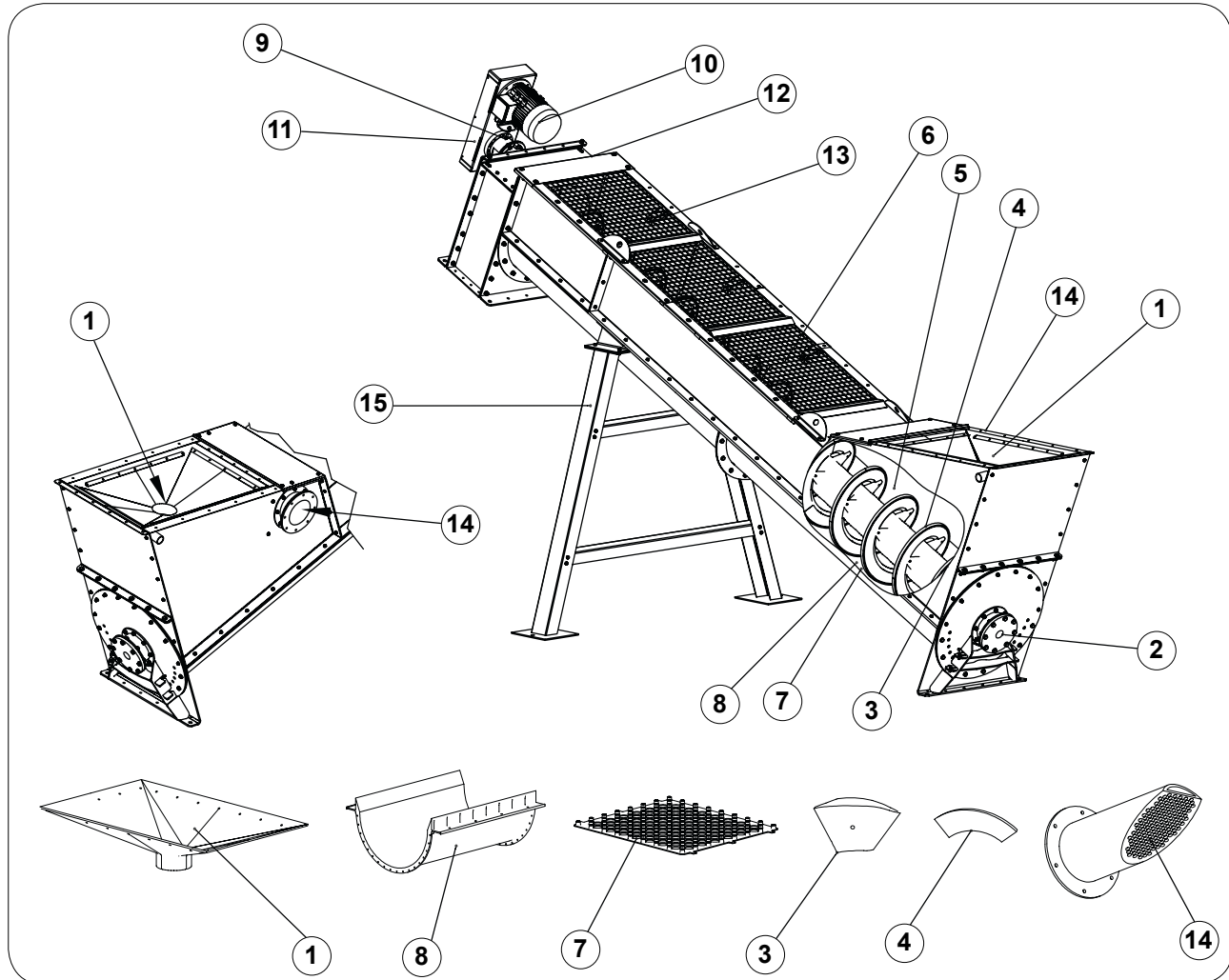
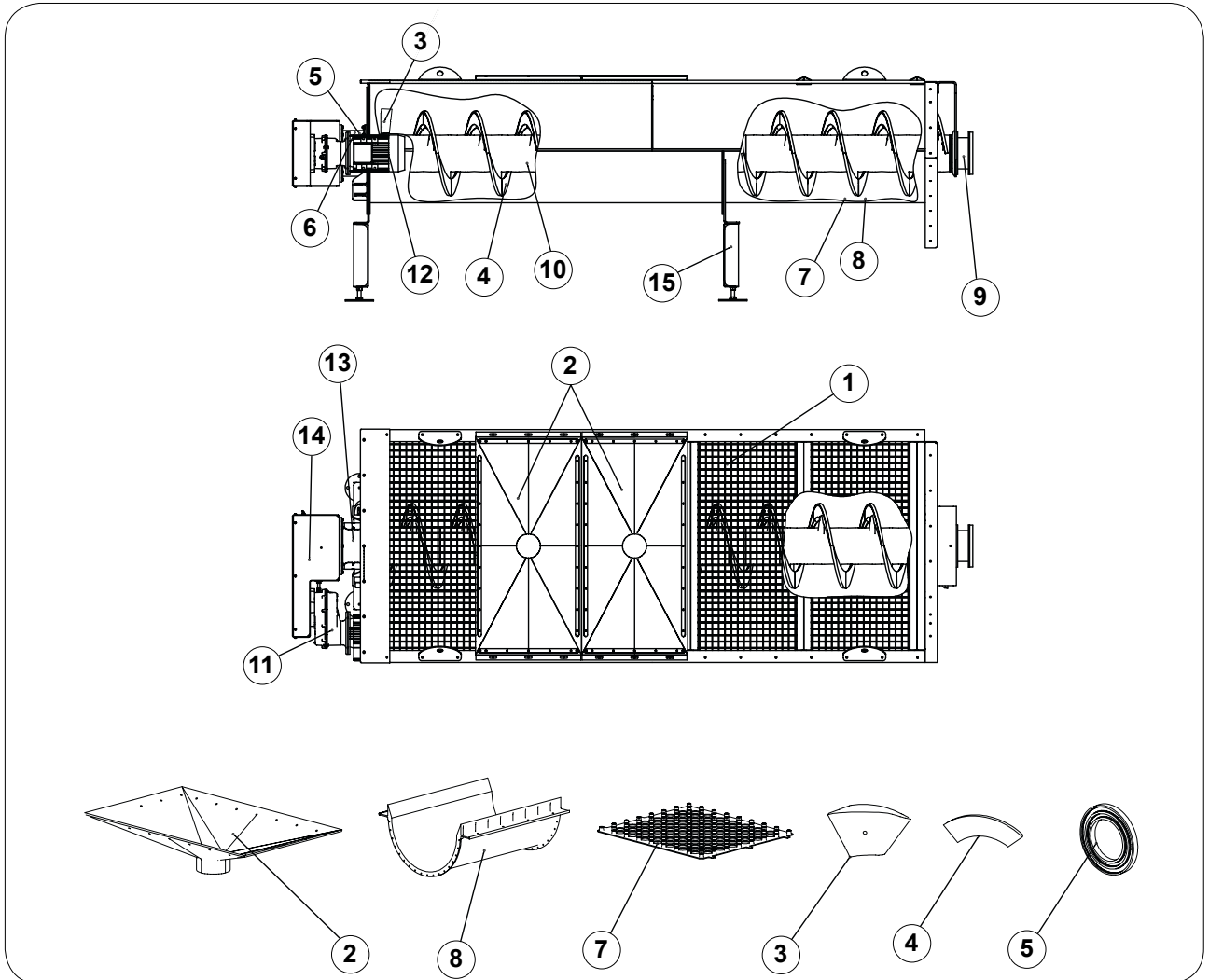

1.3

GRAVEL CLASSIFIER SPARE PARTS (not yet in production)

Pos.	DESCRIPTION	CODE	SPARE PARTS RECOMMENDED
1			
2			
3			
4			
5			
6			
7			
8			
9			
10			
11			
12			
13			
14			
15			
16			

NOTE: The data given in this catalogue are not binding and may undergo changes at any time.



WAM®

WAM S.p.A.
Via Cavour, 338
I - 41030 Ponte Motta
Cavezzo (MO) - ITALY

fax + 39 / 0535 / 618111
+ 39 / 0535 / 618226
e-mail info@wam.it
internet www.wamgroup.com
videoconferenze + 39 / 0535 / 49032

 [®] *manufactured*
by
RONCUZZI